

REV NO	DESCRIPTION	DATE
1	Addendum #2	12/17/2021
2	Addendum #3	12/29/2021
3	Addendum #4	1/4/2022

**CROOKED LAKE  
 ELEMENTARY SCHOOL**  
 HVAC Replacement and Deferred  
 Maintenance - Phase 3  
 Anoka-Hennepin Schools I.S.D. No. 11  
 2939 Blunker Lake Blvd NW  
 Andover, MN 55304

SIGNATURE / SEAL  
 I hereby certify that this plan, specification, or report was prepared by me or under my direct supervision and that I am a duly licensed Architect under the laws of the State of Minnesota.

Signature: *David M. Maroney*  
 David M. Maroney, AIA  
 Typed or printed name: **October 27, 2021**  
 Date: **2021**  
 License Number

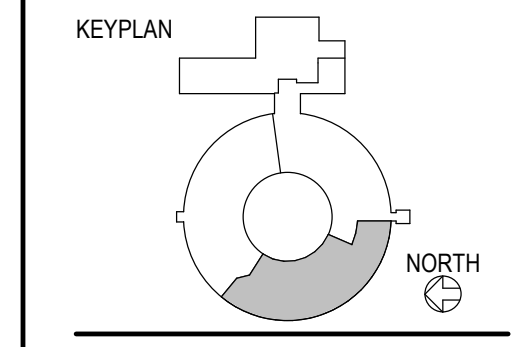

DRAWN BY: **Author**  
 CHECKED BY: **Checker**  
 ISSUED FOR: **CONSTRUCTION DOCUMENTS**  
 ISSUE DATE: **OCTOBER 27, 2021**

SHEET NAME: **LIBRARY FLOOR PLAN AND DEMOLITION PLAN**  
 ATSR PROJECT NO.: **19039.2**  
 REVISION NO.: **3**  
 SHEET NUMBER

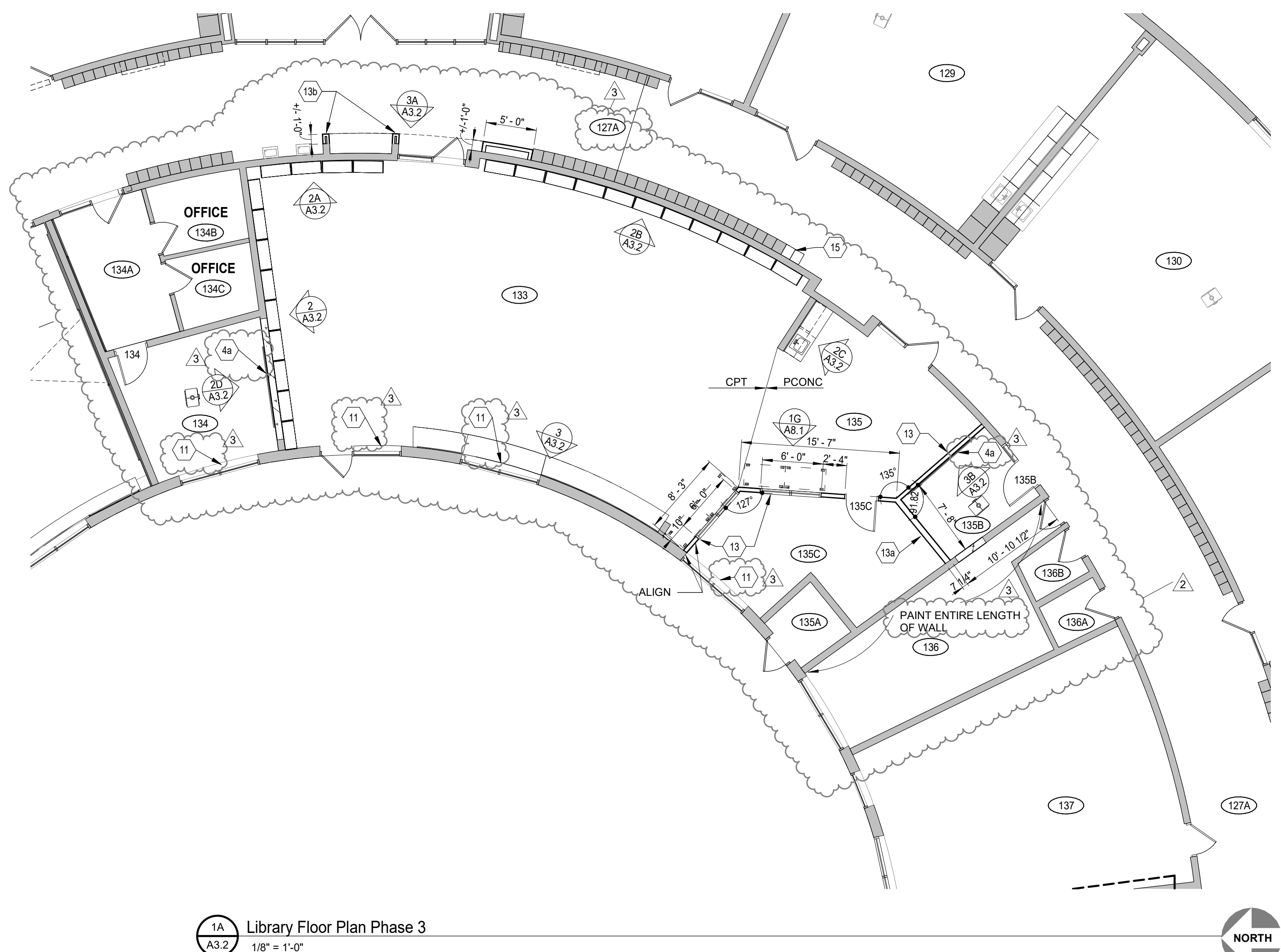

1A Library Floor Plan Phase 3  
 1/8" = 1'-0"

NOTE: SEE SHEET A3.1 FOR DOOR AND ROOM FINISH SCHEDULES

**FLOOR PLAN NOTES**

- 5/8" IMPACT RESISTANT GBD ON 2 1/2" STUD FLOORING @ 16" O.C. FROM FLOOR TO 4" MIN ABOVE CEILING, AND 4 1/2" VINYL BASE
- PAINT ENTIRE LENGTH OF SOFFIT - FROM TOP OF LKRS TO CEILING
- REMOVE TACKSTRIP FROM GBD SOFFIT - PATCH WALL FOR NEW PAINTED FINISH
- EXG PROJECTION BOARD INSTALLED BY CONTRACTOR, COORDINATE INSTALL LOCATION WITH OWNER
- NEW PROJECTION BOARD INSTALLED BY CONTRACTOR, COORDINATE INSTALL LOCATION WITH OWNER
- PATCH OPENING AT REMOVED MECH. EQPT. WITH 5/8" GBD ON STL STUDS, PAINT GBD WALL - COORD W/MECH
- DISPLACEMENT TERMINAL UNIT. SEE MECH
- EWC SEE 2FA8.1 COORDINATE WITH MECH
- PROVIDE TRANSITION BETWEEN TERRAZZO AND POLISHED CONCRETE - SEE SPECIFICATIONS, SEE DETAIL 2C / A8.1
- PAINT DOOR FRAMES BOTH SIDES
- WALL MOUNTED CLOCK ON METAL COVER PLATE BY ELECTRICAL - PAINT PLATE TO MATCH WALL
- PATCH AND PAINT CMU/GBD AS REQUIRED WHERE EXISTING OPENINGS ARE NO LONGER IN USE, COORDINATE WITH MECHANICAL
- PROVIDE 3/8" ADHESION GBD WALL FINISH FROM TOP OF CT WAINSCOT (+24") TO 4" ABOVE CEILING
- STL STUD PARTITION - 5/8" GBD EACH SIDE OF 3 5/8" STL STUDS FROM FLOOR TO ROOF DECK - PROVIDE AC BATT INSUL AND AC SEALANT AT PERIMETER AND ALL PENETRATIONS
- STL STUD PARTITION - 5/8" GBD EACH SIDE OF 6" STL STUDS FROM FLOOR TO ROOF DECK - PROVIDE AC BATT INSUL AND AC SEALANT AT PERIMETER AND ALL PENETRATIONS
- STL STUD PARTITION - 5/8" GBD ON 3 5/8" STL STUDS FROM FLOOR TO ROOF DECK
- CONVECTOR IN NEW MAS WALL OPENING - PATCH CT WALL TO MATCH
- EXG RELOCATED LOCKERS
- INFILL OPENING AT REMOVED DOOR AND FRAME WITH CMU TO MATCH EXG - PT

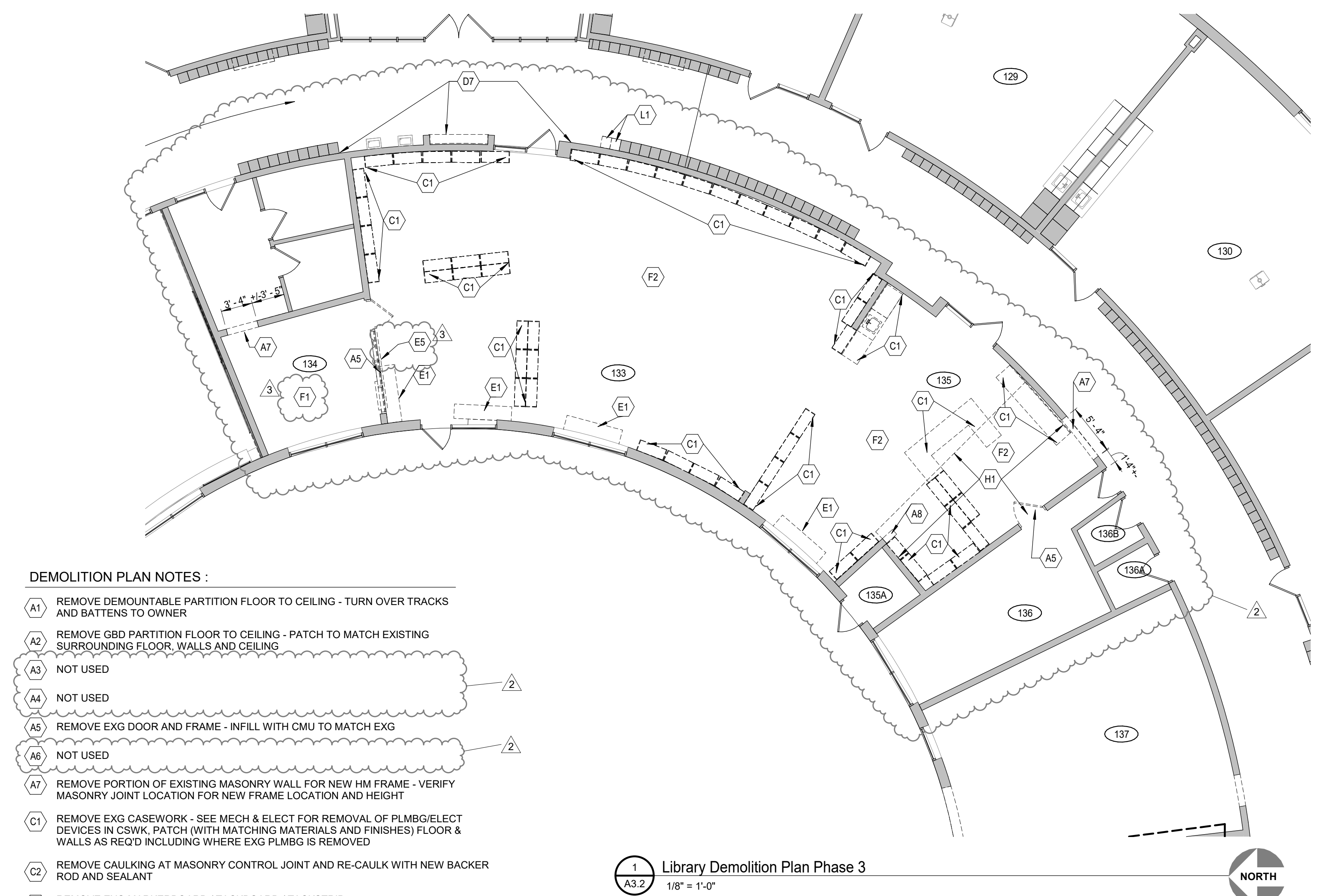

Library Demolition Plan Phase 3  
 1/8" = 1'-0"

**DEMOLITION PLAN NOTES :**

- REMOVE DEMOUNTABLE PARTITION FLOOR TO CEILING - TURN OVER TRACKS AND BATTENS TO OWNER
- REMOVE GBD PARTITION FLOOR TO CEILING - PATCH TO MATCH EXISTING SURROUNDING FLOOR, WALLS AND CEILING
- NOT USED
- NOT USED
- REMOVE EXG DOOR AND FRAME - INFILL WITH CMU TO MATCH EXG
- NOT USED
- REMOVE PORTION OF EXISTING MASONRY WALL FOR NEW HM FRAME - VERIFY MASONRY JOINT LOCATION FOR NEW FRAME LOCATION AND HEIGHT
- REMOVE EXG CASEWORK - SEE MECH & ELEC FOR REMOVAL OF PLUMB/ELECT DEVICES IN CSWIK. PATCH (WITH MATING MATERIALS AND FINISHES) FLOOR & WALLS AS REQ'D INCLUDING WHERE EXG PLUMB IS REMOVED
- REMOVE CAULKING AT MASONRY CONTROL JOINT AND RE-CAULK WITH NEW BACKER ROD AND SEALANT
- REMOVE EXG MARKERBOARD / TACKBOARD / TACKSTRIP. PREP WALL FOR FURRING
- REMOVE EXG CHALKBOARD. PREP WALL FOR NEW MARKERBOARD
- CLEANLY CUT EXG. TACKBOARD TO ACCOMMODATE TALL CABINET INSTALLATION AND MECH EQUIPMENT. VERIFY HEIGHT OF UNIT PRIOR TO CUT
- REMOVE MKBD AND RETAIN FOR OWNER
- REMOVE CLOCK AND SPEAKER - REFER TO ELECTRICAL FOR NEW COVER PLATE
- REMOVE WALL MOUNTED METAL UPPER CABINETS FOR WALL PAINTING AND REINSTALL
- REMOVE RECESSED DISPLAY CASE AND CMU SILL TO EXISTING FLOOR SLAB - PREP EXISTING WALL FOR NEW CT AND FLOOR TO ACCEPT NEW BENCH
- EXISTING MECHANICAL EQUIPMENT REMOVED BY MC - REFER TO MECHANICAL DRAWINGS. PATCH WALL/FLOOR AT REMOVED PIPE LOCATION TO MATCH EXG ADJACENT SURFACE
- CONTRACTOR TO REMOVE AND RE-INSTALL EXG PROJECTION BOARD. REMOVE MOUNTING BRACKETS (WHERE OCCURS)
- OWNER TO REMOVE EXG CEILING-MOUNTED PROJECTOR AND REINSTALL AFTER WORK. CONTRACTOR TO TEMPORARY SUPPORT PROJECTOR PLATE AND REINSTALL IN NEW CEILING. EXG. POWER OUTLET TO REMAIN. CONTRACTOR TO PROTECT WIRING IN PLACE. OWNER TO REMOVE AND REINSTALL L.V. CABLES
- REMOVE 63"W x 32"H PORTION OF 8" CMU WALL FOR NEW CONVECTOR (BOT 6" AFF) - PROVIDE STL L LINTEL AS REQ'D - PATCH CT WALL TO MATCH VERIFY OPG SIZE WITH MECH
- REMOVE EXISTING PROJECTION BOARD - RETAIN FOR OWNER
- REMOVE EXG SURFACE RACEWAY. COORD WITH ELEC
- REMOVE VT FLOORING & BASE (WHERE OCCURS) - PREP FOR NEW POLISHED CONCRETE FLOOR FINISH
- REMOVE CPT FLOORING - PREP FOR NEW CPT FLOORING
- REMOVE CERAMIC WALL TILE AND CT BASE - PREP WALL TO RECEIVE NEW PCT BASE AND CERAMIC WALL TILE
- REMOVE VB AT CMU WALLS - PREP WALL FOR NEW VB
- REMOVE EXG ACT CLG & GRID
- REMOVE AND RELOCATE EXG LOCKERS TO THE OTHER END

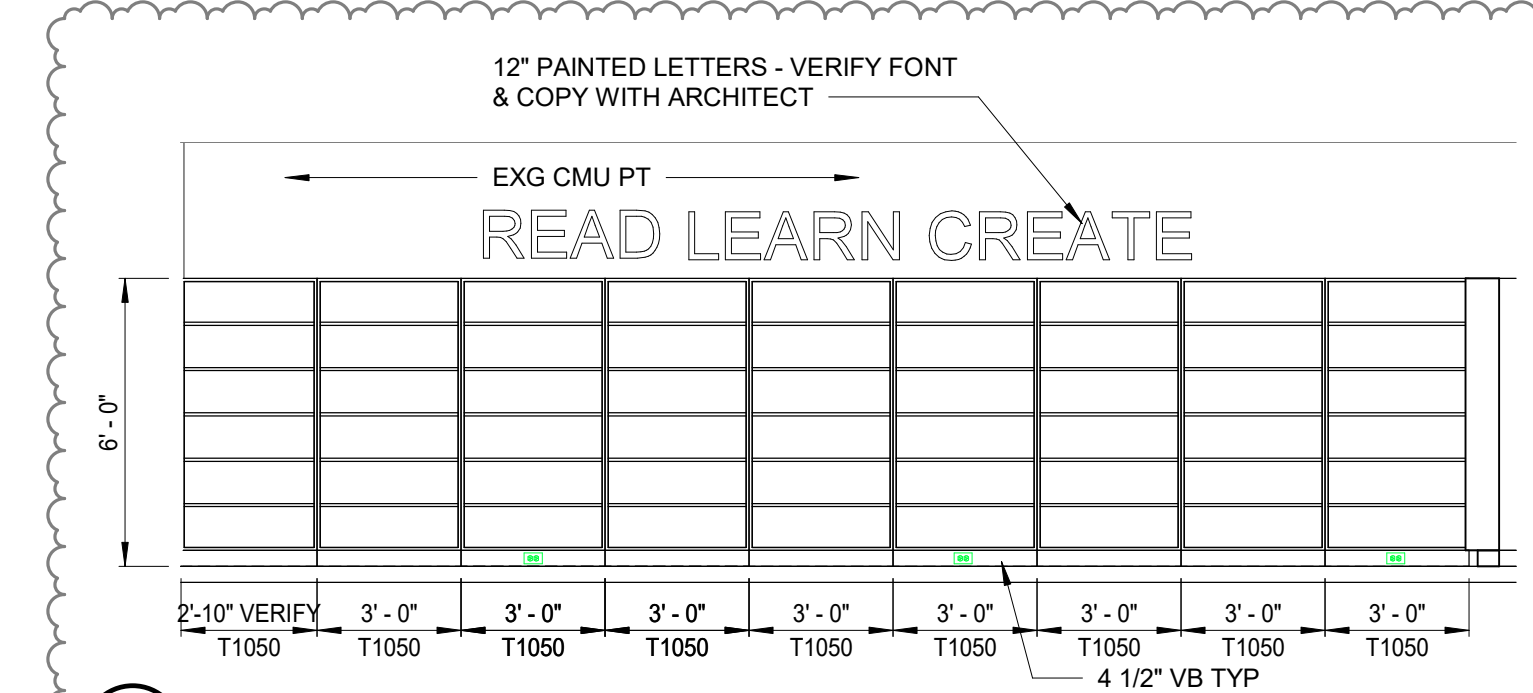

2 Elevation 133 N  
 1/4" = 1'-0"

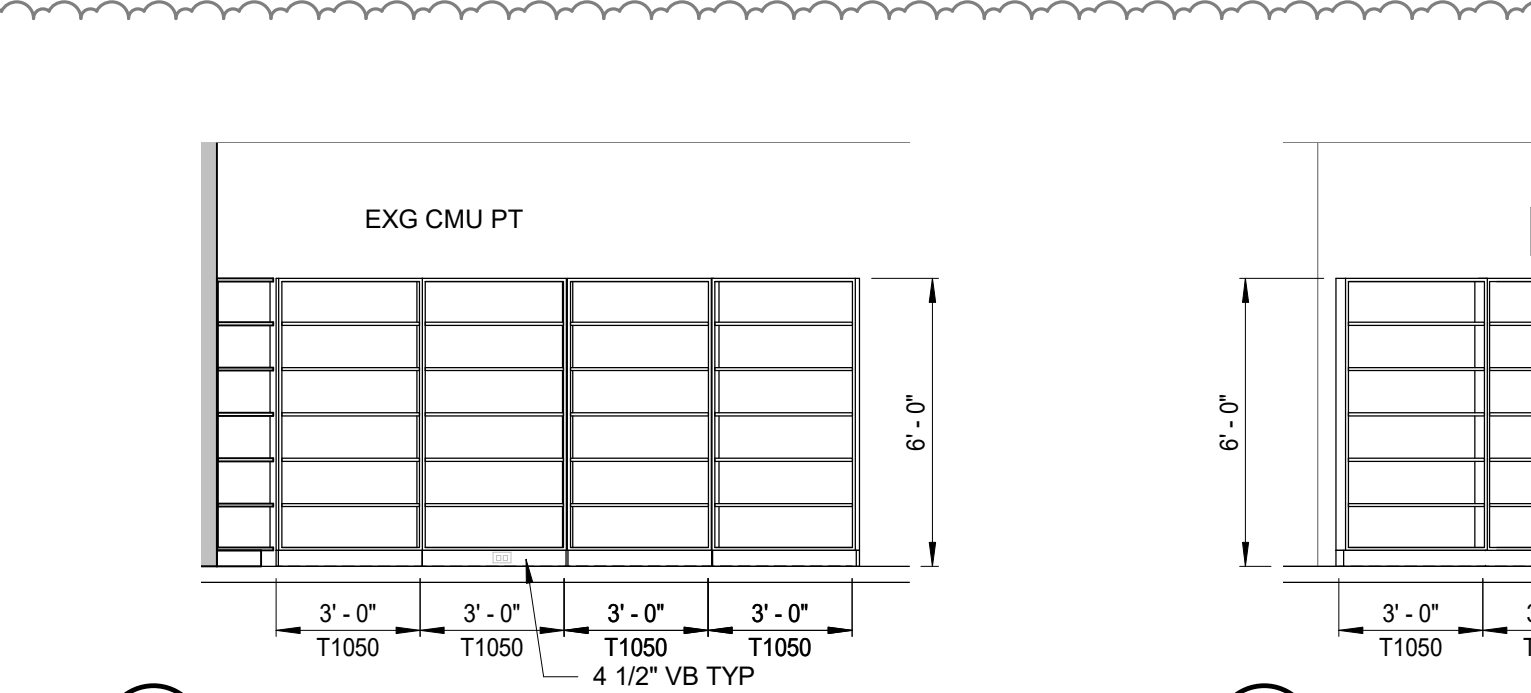

2A Elevation 133 E  
 1/4" = 1'-0"

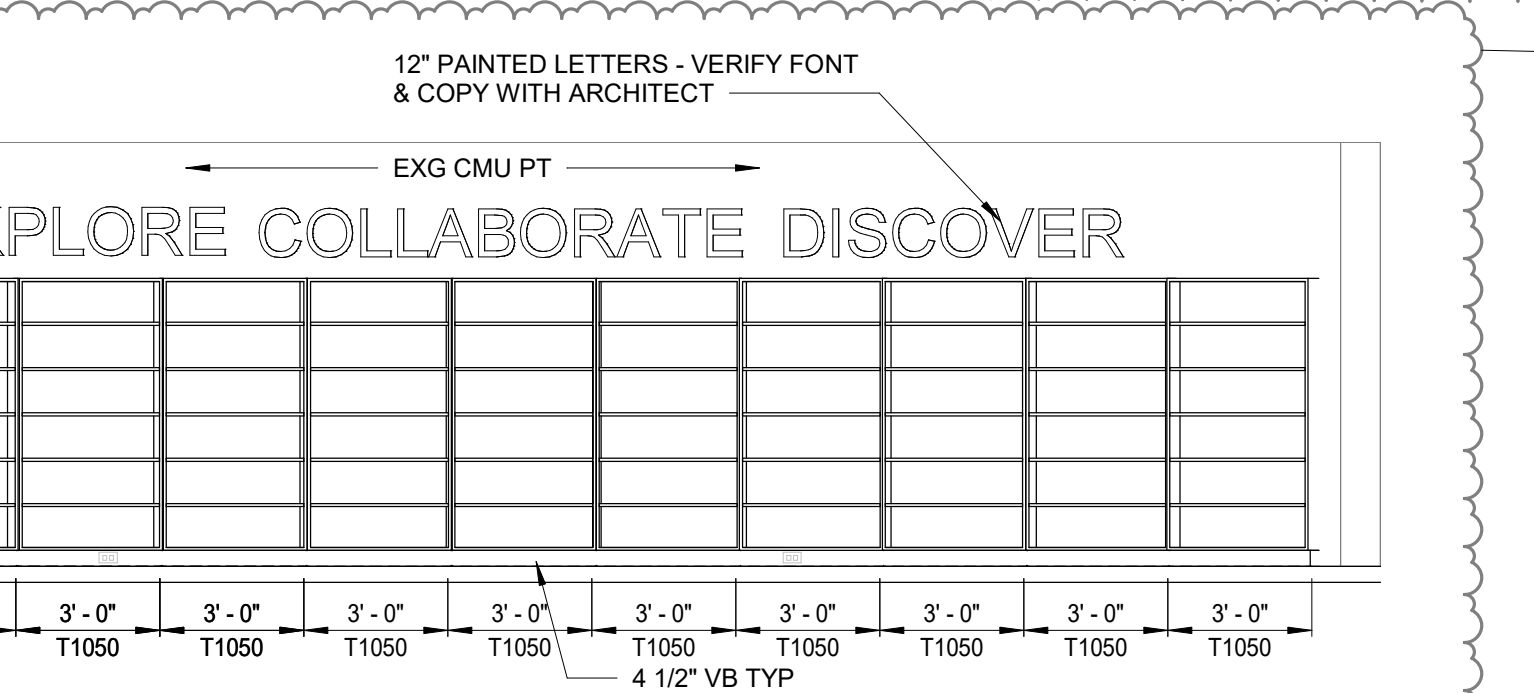

2B Elevation 133 E  
 1/4" = 1'-0"

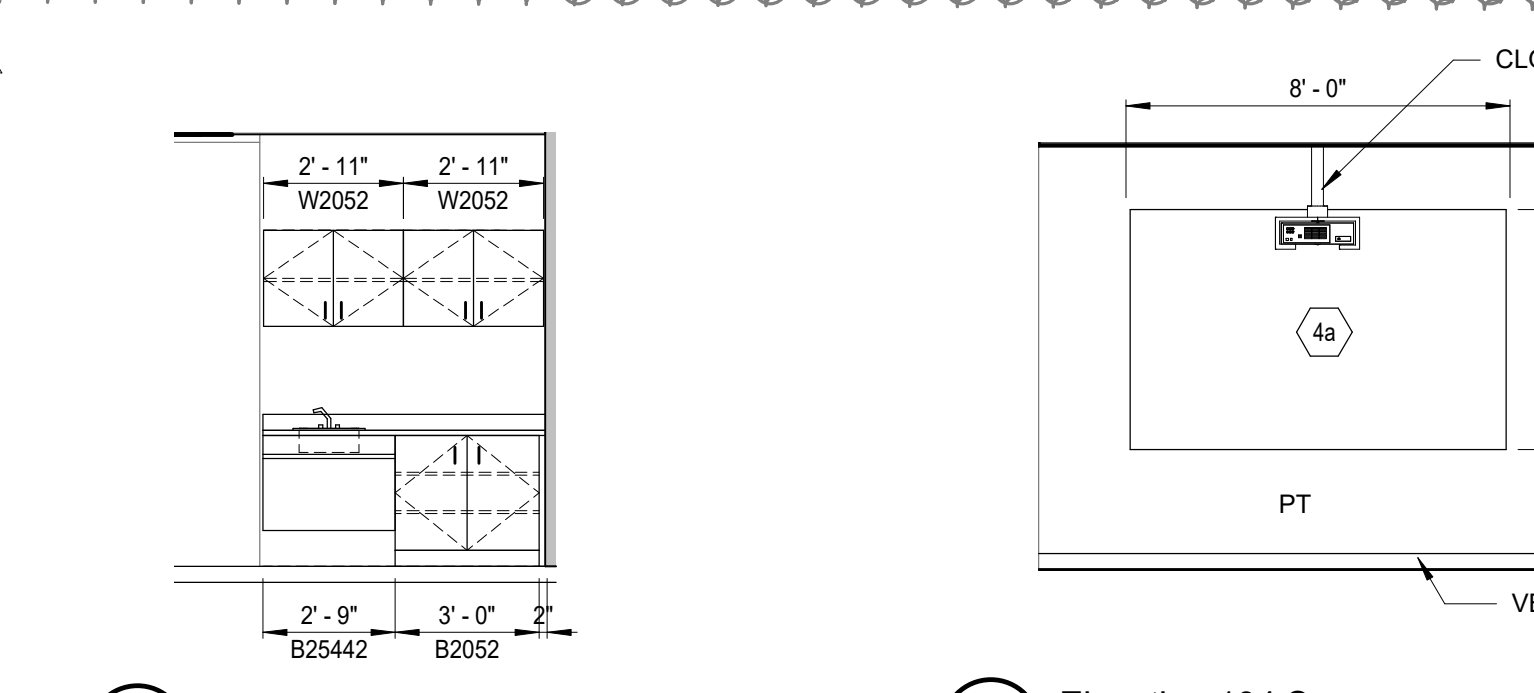

2C Elevation 135 N  
 1/4" = 1'-0"

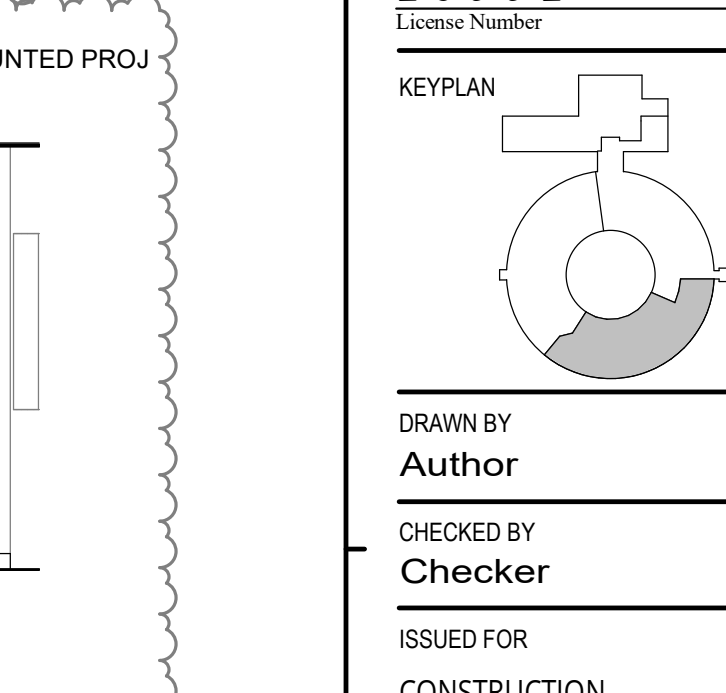

2D Elevation 134 S  
 1/4" = 1'-0"

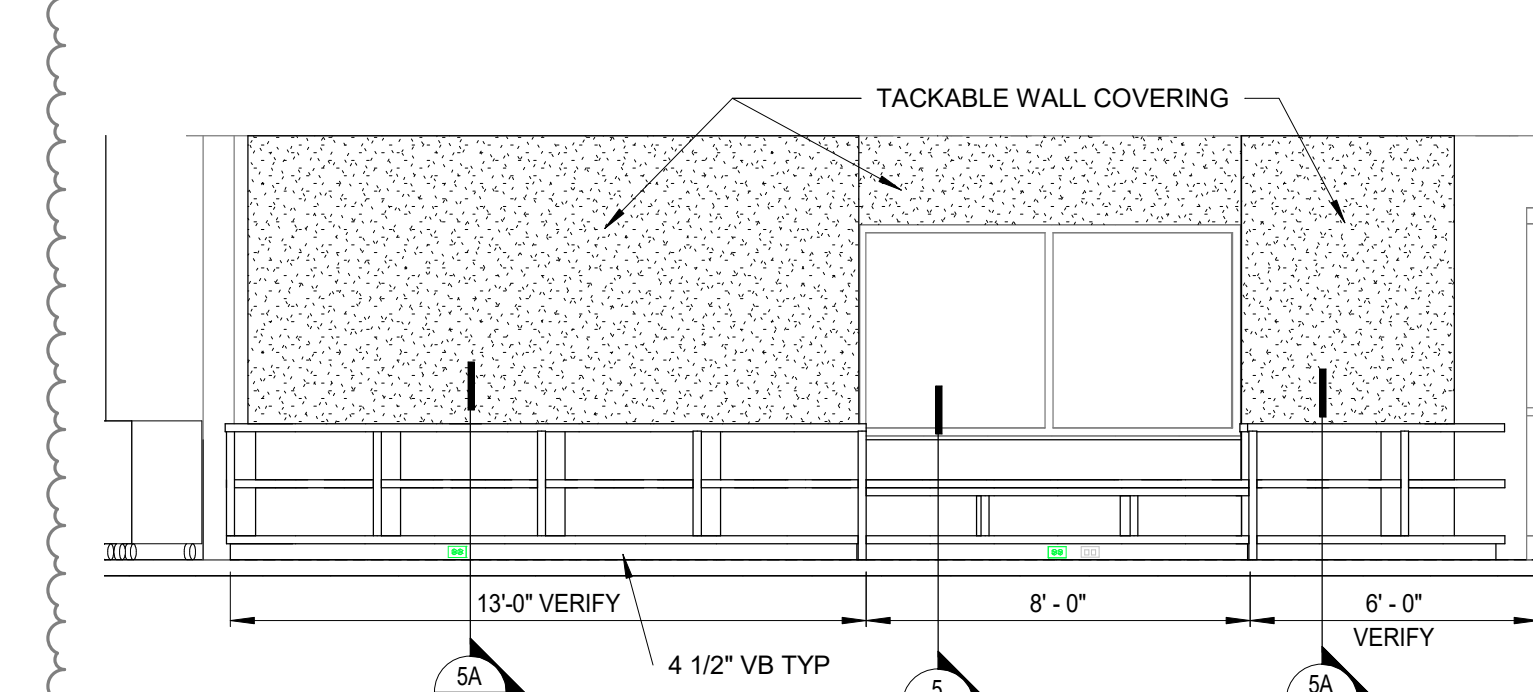

3 Elevation 133 W  
 1/4" = 1'-0"

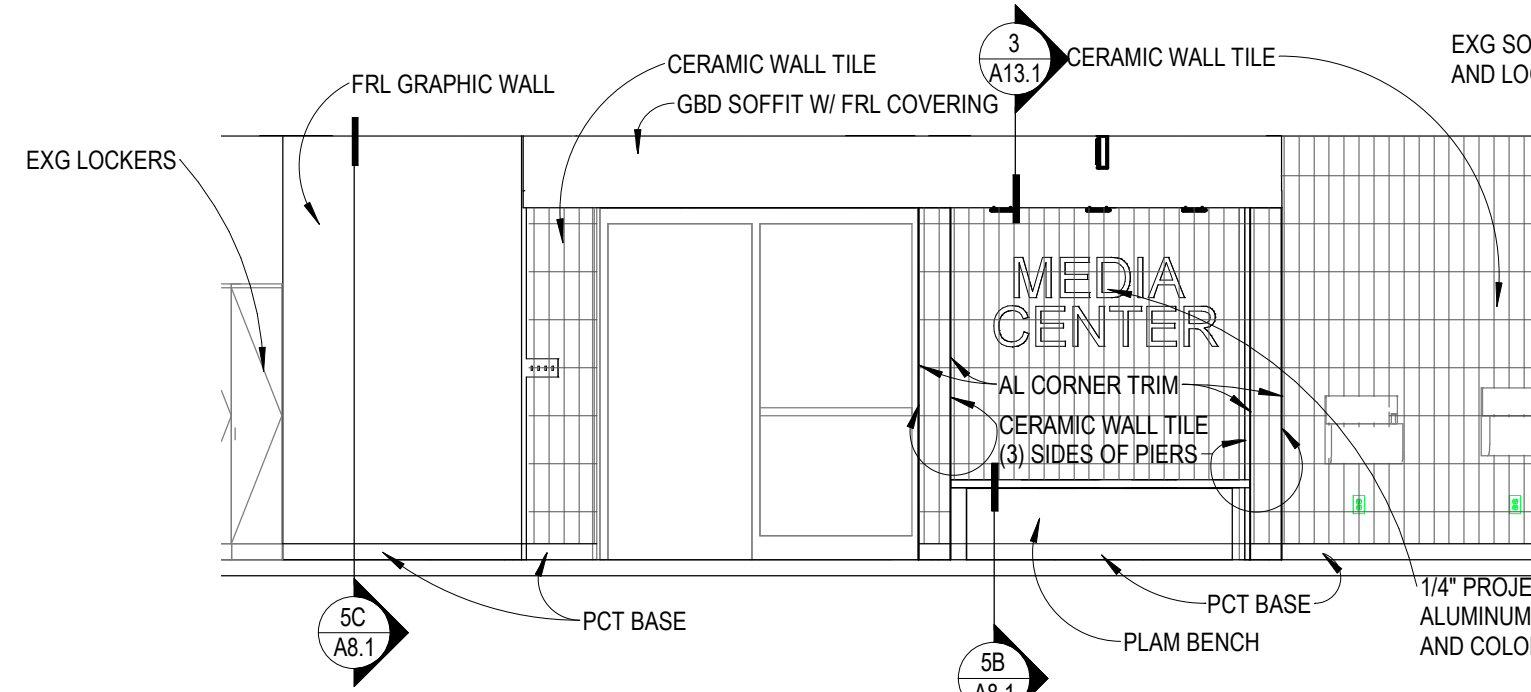

3A Elevation 127A W  
 1/4" = 1'-0"

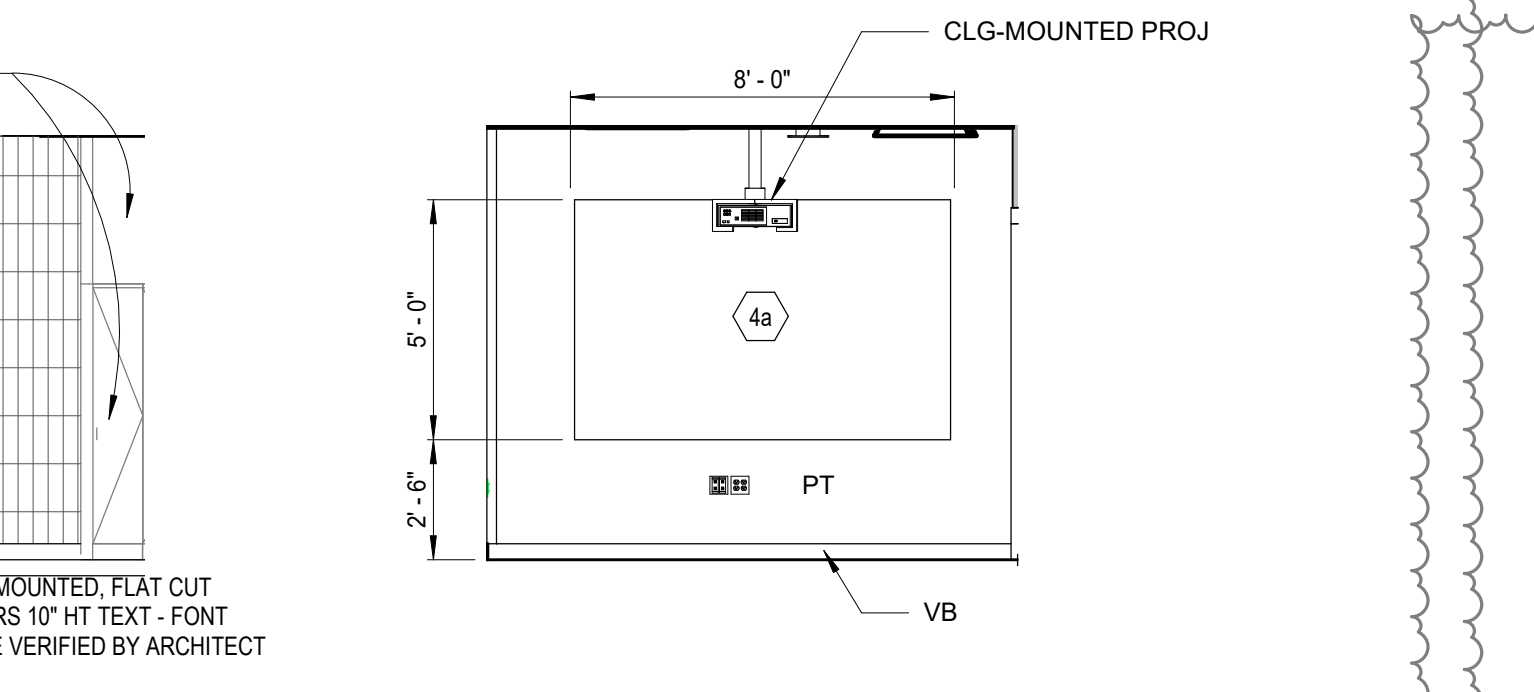

3B Elevation 135B E  
 1/4" = 1'-0"

SHEET ADDED